

## ROTAZIONE CON MANDRINO MACCHINA - SLIMLINE SPINDLE DRIVEN

### RA-100

Diameter without tool with RA-100  
Diametro senza utensile con RA-100

RPM max. output  
Max. Velocità output **5.620 rpm**

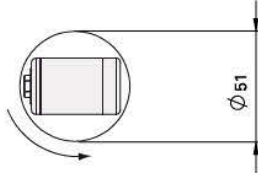

Technical Data / Dati Tecnici		RA-100
RPM max. input / Max. Velocità input		15.000
Rt. reduction / Rt. in riduzione		1/2,67
Weight / Peso	Kg	3,5

### RA-200

Diameter without tool with RA-200  
Diametro senza utensile con RA-200

RPM max. output  
Max. Velocità output **10.000 rpm**

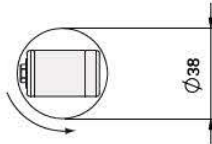

Technical Data / Dati Tecnici		RA-200
RPM max. input / Max. Velocità input		15.000
Rt. reduction / Rt. in riduzione		1/1,5
Weight / Peso	Kg	3,5

### IC-300

Diameter without tool with IC-300  
Diametro senza utensile con IC-300

RPM max. output  
Max. Velocità output **11.250 rpm**

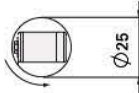

Technical Data / Dati Tecnici		IC-300
RPM max. input / Max. Velocità input		15.000
Rt. reduction / Rt. in riduzione		3/4
Weight / Peso	Kg	3

### MFC-300 S

Diameter without tool with MFC-300  
Diametro senza utensile con MFC-300

RPM max. output  
Max. Velocità output **15.000 rpm**

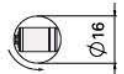

Technical Data / Dati Tecnici		MFC-300
RPM max. input / Max. Velocità input		15.000
Rt. reduction / Rt. in riduzione		1/1
Weight / Peso	Kg	3

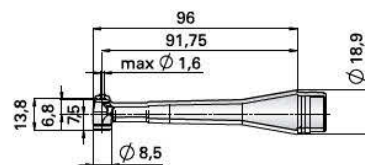
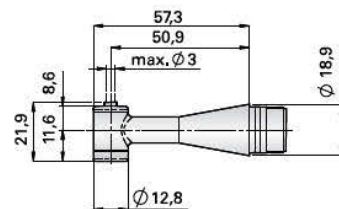
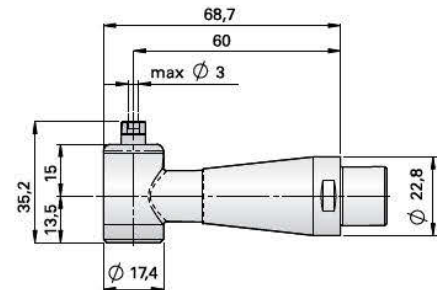
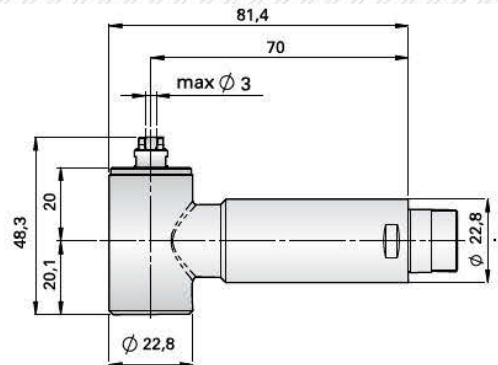

#### Spindle Runout

Spindle accuracy  
Precisione del Mandrino

0,002 mm  
0,00008 inch.



#### Coolant Option

It is possible to use external coolant during the machining.  
Consentito usare refrigerante esterno durante la lavorazione.



#### Collet

RA-100	mm	CH8: Ø3 mm every 0,1 mm Ø 3mm
RA-200	mm	CHS: Ø3mm, 2,35 every 1,6 and Ø2,35, Ø3,175
IC-300	mm	CHC: Ø3mm, Ø2,35mm, Ø1,6 mm, Ø2,00mm and Ø3,175 mm
MFC-300	mm	K252 Ø1,6mm

CN-01

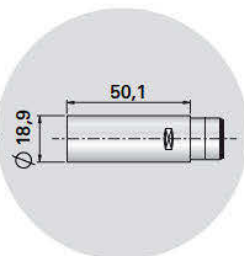

Extension between spindle and heads /  
Prolunga da inserire tra il manipolo e la testa

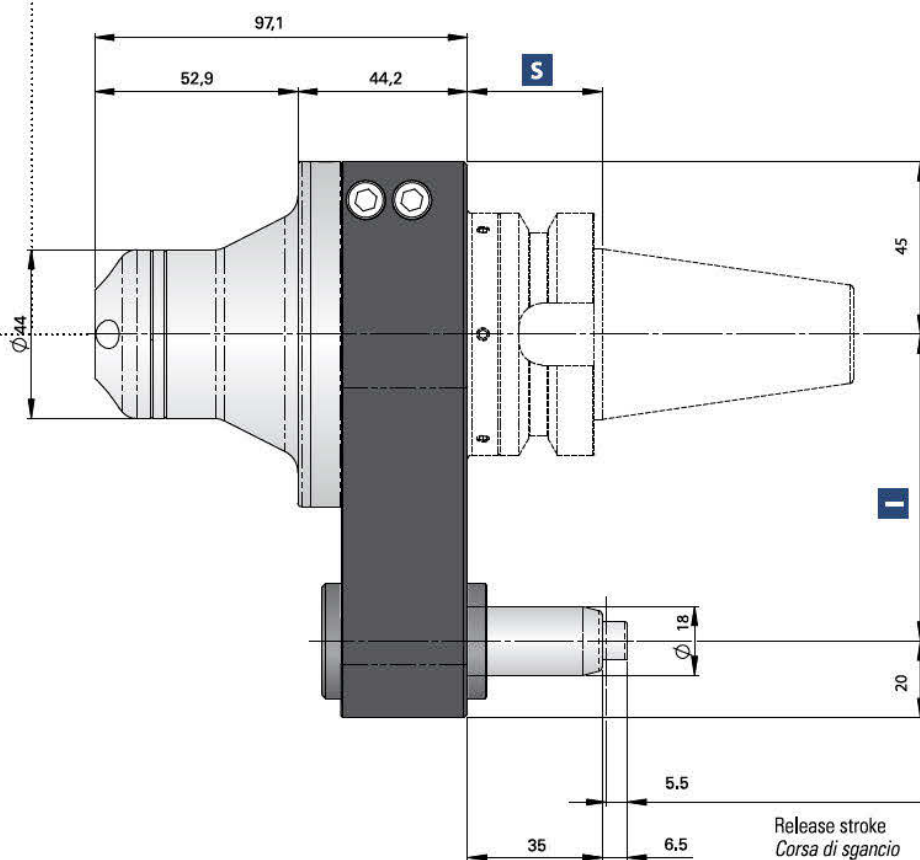

Release stroke  
Corsa di sgancio

**OPTIONAL DRIVE SHANK\***  
Non interchangeable input drive shank  
Coni non intercambiabili

DIN-69871  
ISO 40/50

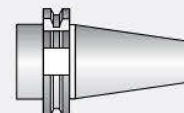

CAT  
40/50

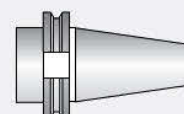

MAS-BT  
40/50

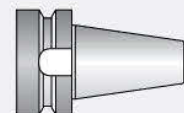

HSK  
63/80/100

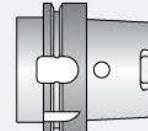

CAPTO  
C5/C6/C8

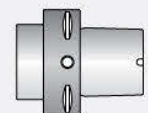

KM  
50/63

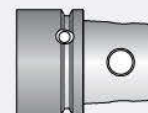

Shank/Cono	DIN-69871	CAT	MAS-BT		HSK		CAPTO		KM
Size/Grandezza	40	50	40	50	63-80	100	C5-C6	C8	50-63
<b>I</b>	65-80-(110*)	80-110	65-80-(110*)	80-110	65-80-(110*)	80-110	65-80-(110*)	80-110	65-80-(110*)
<b>S</b>	35	35	35	41	42	45	38	40	40

\*optional

Accessories / Accessori	RA-100	RA-200	IC-300	MFC-300
Retaining block / Tassello di ritegno	Ø18 mm	Ø18 mm	Ø18 mm	Ø18 mm
Extension / Prolunga	CN-01	CN-01	CN-01	CN-01

Retaining block / Tassello di ritegno /  
Stop-Block



**NOT INCLUDED  
NON INCLUSO**